

WELDED STEEL CHAIN

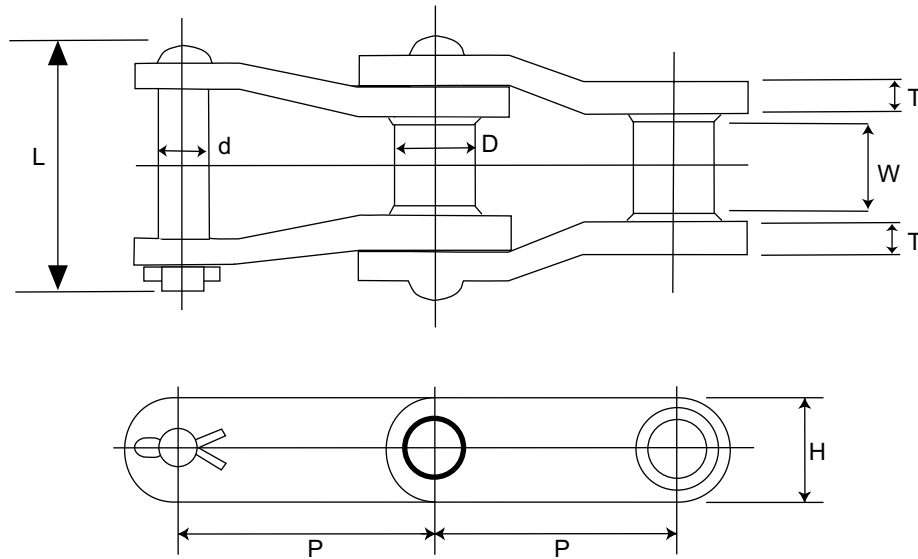

Dimension in Inches and Pounds

Chain Number	Pitch P	Inner Width W	Barrel Diameter D	Pin Diameter d	Link Plate		Pin Length L	Average Tensile Strength	Average Weight Per Foot
					Height H	Thickness T			
WR78	2.609	1.126	0.874	0.500	1.126	0.250	3.031	24,000	4.00
WH78	2.609	1.126	0.874	0.500	1.126	0.250	3.031	31,000	4.00
WR82	3.075	1.252	1.063	0.563	1.252	0.250	3.406	26,000	4.70
WH82	3.075	1.252	1.063	0.563	1.252	0.250	3.406	40,000	4.70
WR124	4.000	1.626	1.378	0.750	1.500	0.375	4.331	46,000	8.58
WH124	4.000	1.626	1.378	0.750	1.500	0.375	4.331	60,000	8.58
WR111	4.760	2.240	1.378	0.750	1.500	0.375	4.961	46,000	6.47
WH111	4.760	2.240	1.378	0.750	1.500	0.375	4.961	60,000	6.47
WR106	6.000	1.614	1.252	0.750	1.500	0.375	4.331	46,000	6.64
WR110	6.000	1.890	1.252	0.750	1.500	0.375	4.528	46,000	8.49
WH110	6.000	1.890	1.252	0.750	1.500	0.375	4.528	60,000	8.49
WR132	6.050	2.992	1.626	1.000	2.000	0.500	6.693	84,000	13.56
WH132	6.050	2.992	1.626	1.000	2.000	0.500	6.693	100,000	13.56

Dimensional data is for reference only. EBC assumes no liability with respect to errors or omissions.

WELDED STEEL